

# R134a GUAGE SETS, COUPLERS & ADAPTERS

©2007, FMSI Automotive Hardware, all rights reserved.

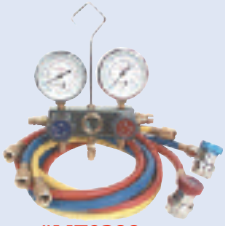

#MT0399

R134a Gauge Set W/72" Hoses & Couplers



#MT0403

R134a Replacement Hose 72" Red



#MT0404

R134a Replacement Hose 72" Blue



#MT0405

R134a Replacement Hose 72" Yellow



#MT0406

R134a Low Side Service Coupling with Shut-off



#MT0407

R134a High Side Service Coupling with Shut-off



#MT0431

Adapter - 1/4" Male to 14mm (R12 conversion to R134a)



#MT0432

Adapter - 1/2" Acme to 1/4" Male (R134a cylinder adapter)

#MT0433

Adapter - 1/4" Female to 1/2" Acme Male (vacuum pump)



#MT0440

R134a Low Side Quick Coupler



#MT0441

R134a High Side Quick Coupler



#MT1032

Anti-blow back valve R134a - 1/2" Acme threads

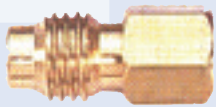

#MT1143

Adapter - 1/4" Female X M10 X 1.5 Male



#MT1144

Adapter - 14mm Male X M12 X 1.75 Male

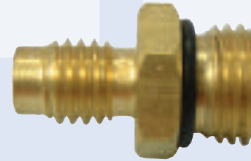

#MT1145

Adapter - 14mm Male X M10 X 1.5 Male



#MT1146

Adapter - 1/2" Acme Male X 1/8" MPT

## RETROFIT KITS

Include 8 oz Ester Oil, steel adapters, O-rings, caps, and retrofit label.



0293 CONTENTS

Most Domestic & Imports Adapters Only

0305 CONTENTS  
Most Domestic & Imports

0305C CONTENTS  
Chrysler with Metal Sealing Gaskets

0306 CONTENTS  
Older Domestic & Dealer Installed Imports

0309 CONTENTS  
'90-93 GM Vehicles With Large Bore (High Flow) Valve

## RETROFIT ADAPTERS

### Aluminum



High Side  
#5037 3/8-24  
#5039 7/16-20

Low Side  
#5038 7/16-20



Primary Seal Port  
#5040 high side

### Aluminum



High Side with cap  
FMSI #5052



90° Elbow High Side  
#5047 3/8-24  
#5049 7/16-20

90° Elbow Low Side  
#5048 7/16-20

### Primary Seal Caps



High Side  
FMSI #5042

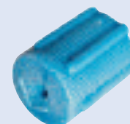

Low Side  
FMSI #5043

### Aluminum



Low Side with cap  
FMSI #5053